



---

**ELEVATOR DOORS**  
AUTOMATIC ELEVATOR DOOR  
MARATHON 3000

**ETG** ELEVATOR  
TRADING

German manufacturer

2-PANEL ONE-SIDE OPENING  
LANDING DOOR

2-PANEL ONE-SIDE OPENING  
CABIN DOOR

## 2-panel one-side opening landing door

### Design:

- EC type examination certificate
- landing door for shaft walls according EN81-58 E120
- installation depth 100mm when mounting in reveal
- door panels underneath adjustable with eccentric
- plastic rollers with ball bearings for good and smooth running of the sliding carriage
- closing device: spring
- door frame as screw construction
- landing apron is included in delivery (steel plate galvanized)
- condition of delivery: demounted / packed in a carton
- standard design of door panels and frames: galvanized
- portal frame 120 mm circular
- protection class of landing door IP21/IP54
- aluminium sill incl. additional sill
- fastening angles above/below
- suitable for one-man mounting



### Options:

- door panels and portal frame in grounded stainless steel, linen or powder coated in standard RAL colours
- cut out for push button
- monitoring of emergency release
- prewired door contact

door variations				
door width in mm	door height in mm		opening variations	
800	2000	2100		
900	2000	2100		

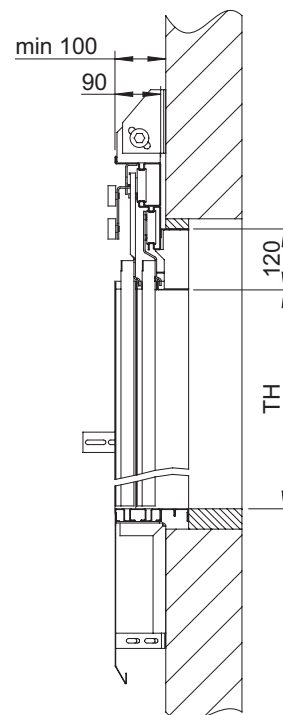
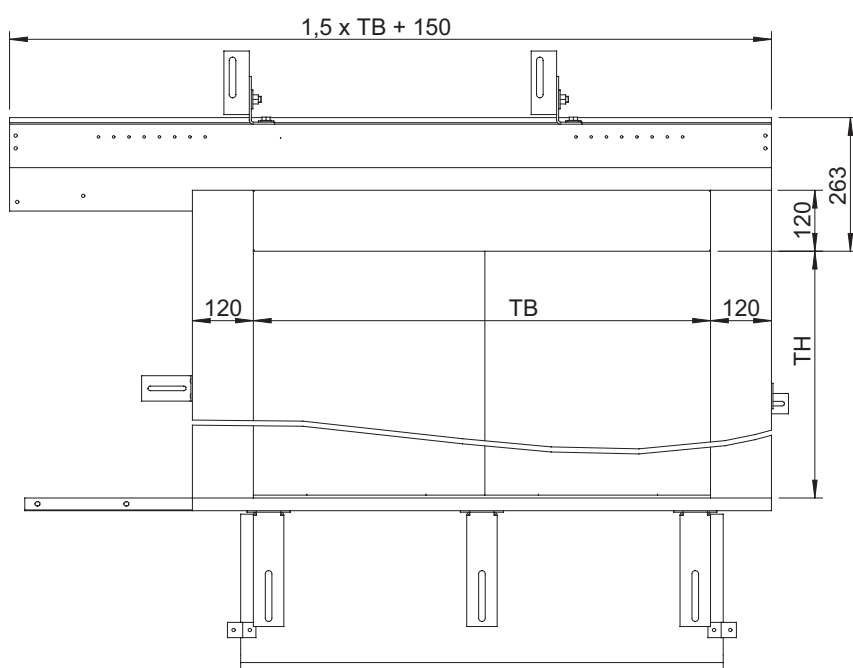

TB = door width / TH = door height

## 2-panel one-side opening cabin door

### Design:

- controlled door drive with LDO AC 4.0 + gearless + brushless motor
- plastic rollers with ball bearing for good and smooth running of sliding carriage
- opening start already possible at 90 mm before leveling
- condition of delivery: demounted / packed in a carton
- standard design of door panels: galvanized
- protection class of cabin door IP21
- aluminium sill
- incl. mechanical cabin door interlock

### Options:

- door panels in grounded stainless steel, linen or powder coated in standard RAL colours
- light beam curtain with adapter kit
- cabin door apron with stiffenings
- fixation at cabin above/below
- prewired door contact



## LDO AC 4.0 – intelligent comfort elevator door drive with frequency converter and gearless + brushless motor

### Features and advantages of LDO AC 4.0:

- gearless drive unit with brushless synchronous motor
- automatic determination of door panel masses at the calibration run test and automatic choice of a predetermined driving cycle
- easy control-unit
- monitoring of position and speed
- automatic detection of rotating direction
- adjustable speed profile
- adjusting of parameter with every W-LAN capable tool
- **CAN-BUS and data provision function**

LDO AC 4.0





---

---

# ETG ELEVATOR TRADING

---

---

German manufacturer

Kömmlitzer Straße 5  
D-04519 Rackwitz

Phone: +49-34 294-1797-00

Fax: +49-34 294-1797-33



[info@elevator-trading.de](mailto:info@elevator-trading.de)  
[www.elevator-trading.de](http://www.elevator-trading.de)

---